

FLORIDA HILLS PHASE III

A SUBDIVISION IN SECTIONS 3 AND 4, TOWNSHIP 5 SOUTH, RANGE 15 EAST, SUWANNEE COUNTY, FLORIDA.

PLAT BOOK I, PAGE 302

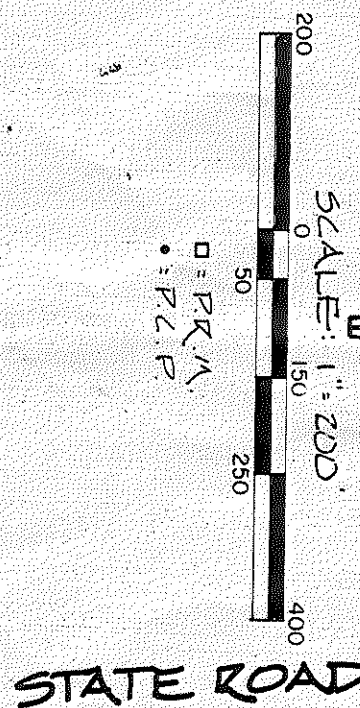
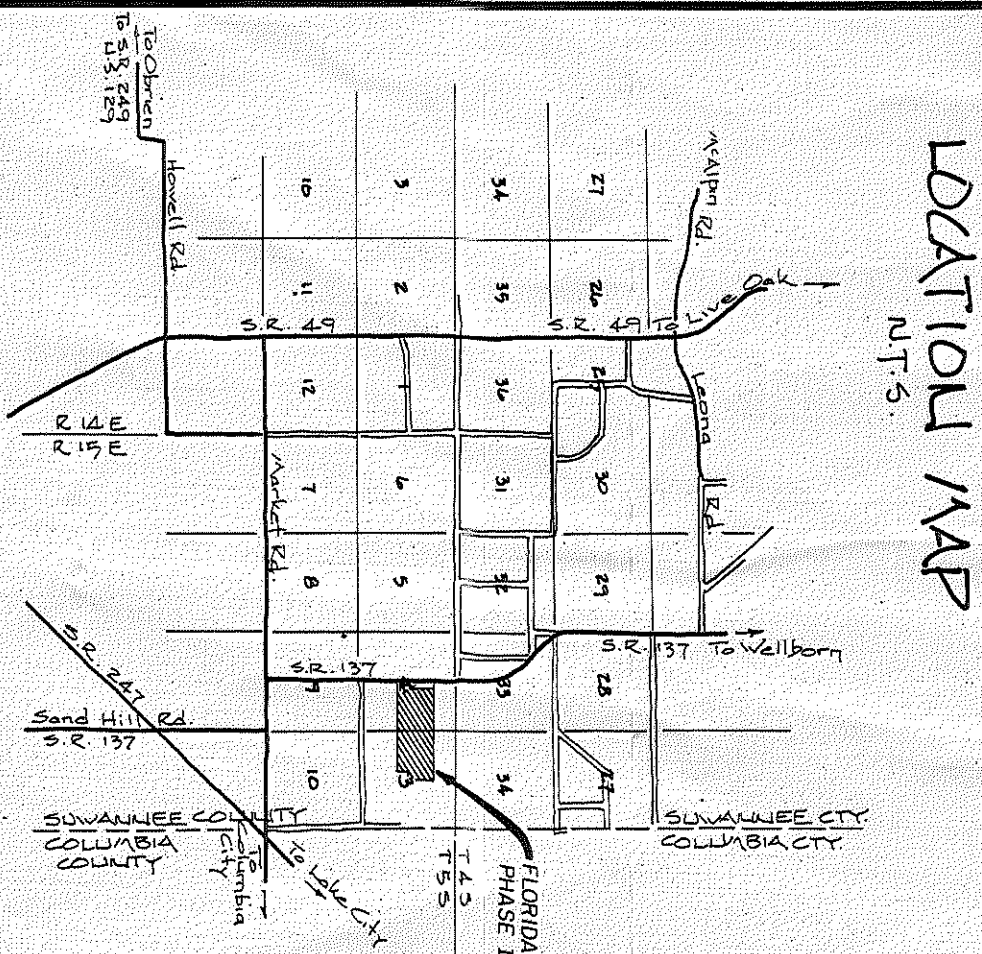

LEGAL DESCRIPTION
 A PORTION OF SECTIONS 3 AND 4, TOWNSHIP 5 SOUTH, RANGE 15 EAST, SUWANNEE COUNTY, FLORIDA, BEING MORE PARTICULARLY DESCRIBED AS FOLLOWS: COMMENCE AT THE NORTHEAST CORNER OF THE NORTHWEST QUARTER OF SAID SECTION 3 AND RUN THENCE S. 0° 37' 59" E. ALONG THE EAST BOUNDARY OF SAID QUARTER 1245.44 FEET TO THE POINT OF BEGINNING, THENCE CONTINUOUSLY S. 0° 37' 59" E. ALONG SAID EAST BOUNDARY OF THE NORTHWEST QUARTER 77.70 FEET TO THE SOUTHEAST CORNER OF THE SOUTH HALF OF SAID NORTHWEST QUARTER, THENCE S. 0° 37' 59" E. ALONG THE EAST BOUNDARY OF THE SOUTH HALF OF SAID NORTHWEST QUARTER 544.00 FEET, THENCE S. 88° 36' 15" W. 548.05 FEET TO THE POINT OF BEGINNING OF THE SOUTH HALF OF SAID NORTHWEST QUARTER, THENCE S. 88° 36' 15" W. 422.50 FEET TO THE NORTHEAST CORNER OF BLOCK 1 OF SAID SUBDIVISION, THENCE CONTINUOUSLY IN PLAT BOOK I, ADOPTED AND RECORDED IN SUWANNEE COUNTY, FLORIDA, BEING MORE PARTICULARLY DESCRIBED AS FOLLOWS: SAID POINT BEING AT THE EASTERN RIGHT-OF-WAY LINE OF STATE ROAD NO. 137, THENCE N. 0° 23' 45" E. ALONG SAID RIGHT-OF-WAY LINE 60.00 FEET TO THE SOUTHWEST CORNER OF SAID BLOCK 1, THENCE S. 88° 36' 15" E. ALONG THE SOUTHWEST CORNER OF SAID BLOCK 1, A DISTANCE OF 440.00 FEET TO THE NORTHEAST CORNER OF SAID BLOCK 2, THENCE S. 0° 23' 45" E. ALONG THE EAST BOUNDARY OF SAID BLOCK 2, A DISTANCE OF 440.00 FEET TO THE SOUTHWEST CORNER OF SAID BLOCK 2, THENCE N. 0° 23' 45" E. ALONG SAID BOUNDARY OF SAID BLOCK 2, A DISTANCE OF 1000.15 FEET TO THE NORTHEAST CORNER OF SAID BLOCK 2, THENCE N. 88° 36' 15" E. 422.50 FEET TO THE POINT OF BEGINNING, BEING 218.02 ACRES, MORE OR LESS.



4-5-15

3-5-15

ADOPTED / DEDICATION
 SUWANNEE COUNTY INVESTMENTS, INC., A FLORIDA CORPORATION, DOES HEREBY CERTIFY THAT IT IS THE OWNER OF THE HEREIN DESCRIBED PROPERTY AND DOES HEREBY DEDICATE TO THE PUBLIC THE STREETS AND EASEMENTS AS SHOWN ON THIS PLAT OF FLORIDA HILLS PHASE III.
 Witness my hand and the seal of this office this 1st day of December, 1982.
 Notary Public - State of Florida
 My Commission Expires Aug. 21, 1983

MORTGAGEE
 KNOW ALL MEN BY THESE PRESENTS THAT THE STATE EXCHANGE BANK, BEING THE HOLDER OF THAT CERTAIN MORTGAGE FILED FOR RECORD IN OFFICIAL RECORDS BOOK PAGE 178-183 OF THE PUBLIC RECORDS OF SUWANNEE COUNTY, FLORIDA, DOES HEREBY CONSENT TO THIS PLAT AND JOIN IN THE DEDICATION HEREON.
 Witness my hand and official seal.
 Notary Public - State of Florida
 My Commission Expires

MORTGAGEE
 KNOW ALL MEN BY THESE PRESENTS THAT THE TRIDENT FINANCIAL CORPORATION S.V.A., A CORPORATION EXISTING UNDER THE LAWS OF THE NETHERLANDS, BEING THE HOLDER OF THAT CERTAIN MORTGAGE FILED FOR RECORD IN OFFICIAL RECORDS BOOK PAGE 178-183 OF THE PUBLIC RECORDS OF SUWANNEE COUNTY, FLORIDA, DOES HEREBY CONSENT TO THIS PLAT AND JOIN IN THE DEDICATION HEREON.
 Witness my hand and official seal.
 Notary Public - State of Florida
 My Commission Expires

SURVEYOR'S CERTIFICATE
 I DO HEREBY CERTIFY THAT THIS PLAT OF FLORIDA HILLS PHASE III IS A TRUE AND CORRECT REPRESENTATION OF THE HEREON DESCRIBED LANDS ACCORDING TO A SURVEY MADE UNDER MY RESPONSIBLE DIRECTION AND SUPERVISION AND THAT PERMANENT REFERENCE MONUMENTS (P.M.'S) AND PERMANENT CONTROL POINTS (C.P.'S) HAVE BEEN SET AS CALLED FOR BY THE PLAT AND THAT THE SURVEY DATA COMPLETES WITH ALL THE REQUIREMENTS OF CHAPTER 117 (F.S.) 1982.
 Notary Public - State of Florida
 My Commission Expires

SUWANNEE COUNTY COMMISSIONER'S APPROVAL
 APPROVED BY THE BOARD OF COMMISSIONERS OF SUWANNEE COUNTY, FLORIDA THIS 11th DAY OF DECEMBER, AD 1982.
 Chairman
 Clerk
 Clerk - Attest
SUWANNEE COUNTY CLERK'S CERTIFICATE OF FILING
 THIS PLAT HAS BEEN FILED FOR RECORD AND RECORDED IN THE PUBLIC RECORDS OF SUWANNEE COUNTY, FLORIDA THIS 11th DAY OF DECEMBER, AD 1982.

ON MAP OLD
 POINT OF COMMENCEMENT
 THE CORNER OF THE NW 1/4 OF SEC. 3-5-15
 1245.44
 50° 37' 59" E
 177.76
 50° 23' 45" E
 563.55
 50° 23' 45" E
 563.55
 1105 N.E. 19th AVE
 SUWANNEE COUNTY, FL
 GRIMESVILLE, FL 32110
 #00714-030010
 SUWANNEE COUNTY, FL
 1105 N.E. 19th AVE
 GRIMESVILLE, FL 32110
 177.76
 50° 23' 45" E
 563.55
 50° 23' 45" E
 563.55
 1105 N.E. 19th AVE
 SUWANNEE COUNTY, FL
 GRIMESVILLE, FL 32110
 177.76
 50° 23' 45" E
 563.55
 50° 23' 45" E
 563.55
 1105 N.E. 19th AVE
 SUWANNEE COUNTY, FL
 GRIMESVILLE, FL 32110

ACKNOWLEDGEMENT
 STATE OF FLORIDA, COUNTY OF SUWANNEE
 THE FOREGOING INSTRUMENT WAS ACKNOWLEDGED BEFORE ME THIS 1st DAY OF DECEMBER, AD 1982 BY SUWANNEE COUNTY INVESTMENTS, INC., PRESIDENT AND SUWANNEE COUNTY INVESTMENTS, INC., VICE PRESIDENT AND SUWANNEE COUNTY INVESTMENTS, INC., VICE PRESIDENT, ALL OF WHOM ARE OFFICIALS OF SAID SUWANNEE COUNTY.
 WITNESSES
 Notary Public - State of Florida
 My Commission Expires

ACKNOWLEDGEMENT
 STATE OF FLORIDA, COUNTY OF SUWANNEE
 THE FOREGOING INSTRUMENT WAS ACKNOWLEDGED BEFORE ME THIS 1st DAY OF DECEMBER, AD 1982 BY SUWANNEE COUNTY INVESTMENTS, INC., PRESIDENT AND SUWANNEE COUNTY INVESTMENTS, INC., VICE PRESIDENT, ALL OF WHOM ARE OFFICIALS OF SAID SUWANNEE COUNTY.
 WITNESSES
 Notary Public - State of Florida
 My Commission Expires

ACKNOWLEDGEMENT
 STATE OF FLORIDA, COUNTY OF SUWANNEE
 THE FOREGOING INSTRUMENT WAS ACKNOWLEDGED BEFORE ME THIS 1st DAY OF DECEMBER, AD 1982 BY SUWANNEE COUNTY INVESTMENTS, INC., PRESIDENT AND SUWANNEE COUNTY INVESTMENTS, INC., VICE PRESIDENT, ALL OF WHOM ARE OFFICIALS OF SAID SUWANNEE COUNTY.
 WITNESSES
 Notary Public - State of Florida
 My Commission Expires

ACKNOWLEDGEMENT
 STATE OF FLORIDA, COUNTY OF SUWANNEE
 THE FOREGOING INSTRUMENT WAS ACKNOWLEDGED BEFORE ME THIS 1st DAY OF DECEMBER, AD 1982 BY SUWANNEE COUNTY INVESTMENTS, INC., PRESIDENT AND SUWANNEE COUNTY INVESTMENTS, INC., VICE PRESIDENT, ALL OF WHOM ARE OFFICIALS OF SAID SUWANNEE COUNTY.
 WITNESSES
 Notary Public - State of Florida
 My Commission Expires